

# Teams Badges

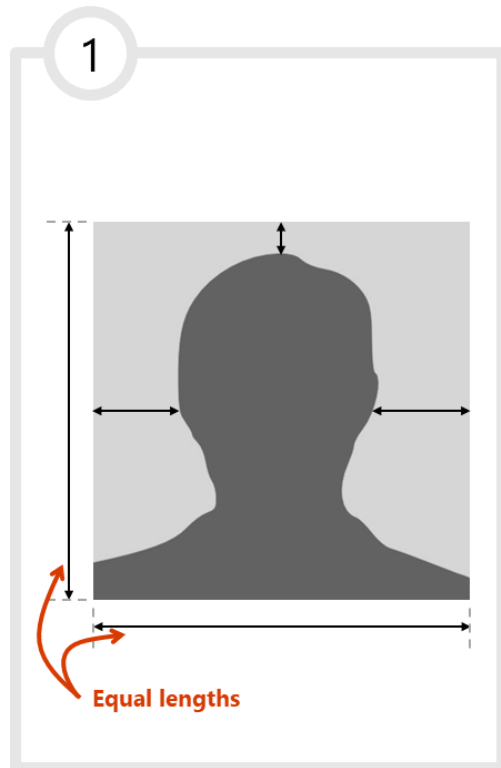

# Badges & social frames how to guide

Here's how to overlay this badge/frame onto profile images (this works for Microsoft Teams images and social media profiles).



You will need picture with equal square dimensions and plenty of space around the head saved somewhere on your computer. A photo of unequal dimensions will render with distorted results

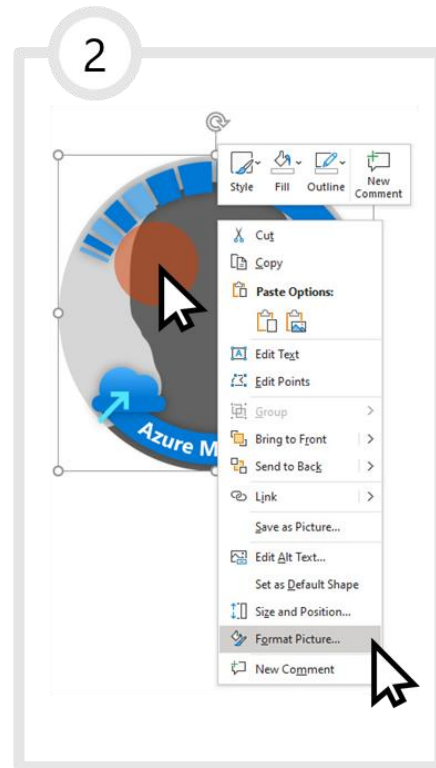

Right click on the top part of the picture and select \*Format Picture...-

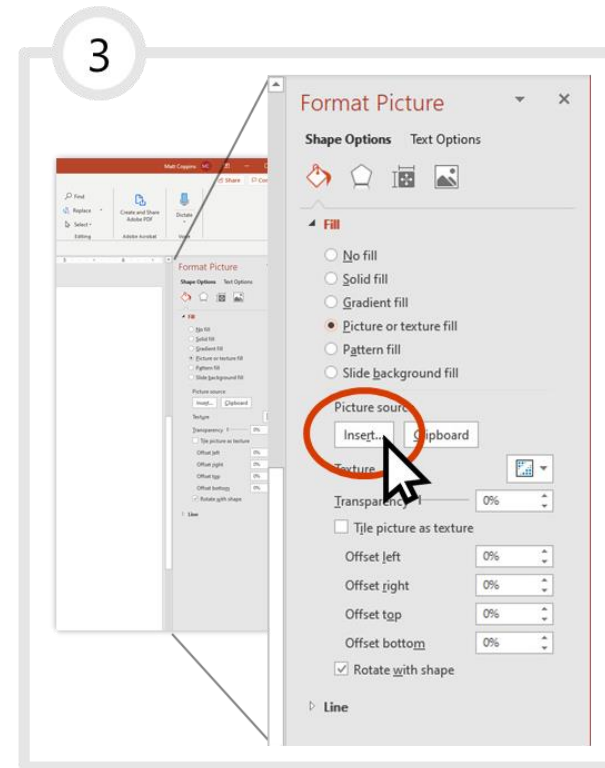

Click "Insert" and navigate to your saved profile photo and click ok. Note that the text in the image frame is editable if you need to adjust.

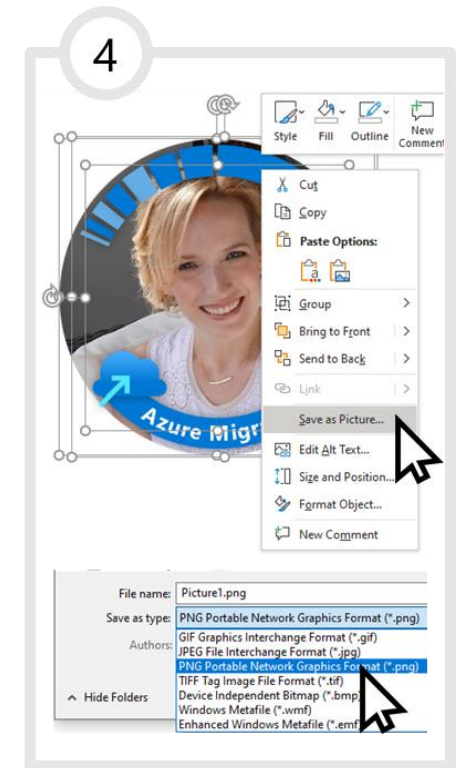

Once the photo is placed. hold Shift and select both the circled photo and photo graphics, right-click. Then select •Save as Picture...-. select PNG file format. and then save to your computer

# Badges & social frames

## Files you'll need:

- None! You can build them in this PowerPoint

## How to start using these images:

1. Follow the steps on slide 4

